

vtech[®]

Instruction Manual

Workout Buddies Bag[™]



INTRODUCTION

Thank you for purchasing the **Workout Buddies Bag™**.

This take-along pretend workout set is a great way to get little ones moving and learning. Press the number buttons to learn about fitness, numbers, exercise activities and colors. Press the light-up music button to play music and encourage your little one to groove as they move. The nubby ball, play dumbbell, soft towel, music player and water bottle rattle give your baby lots of opportunities to explore textures and exercise fine motor skills. Store all items in the soft workout bag.

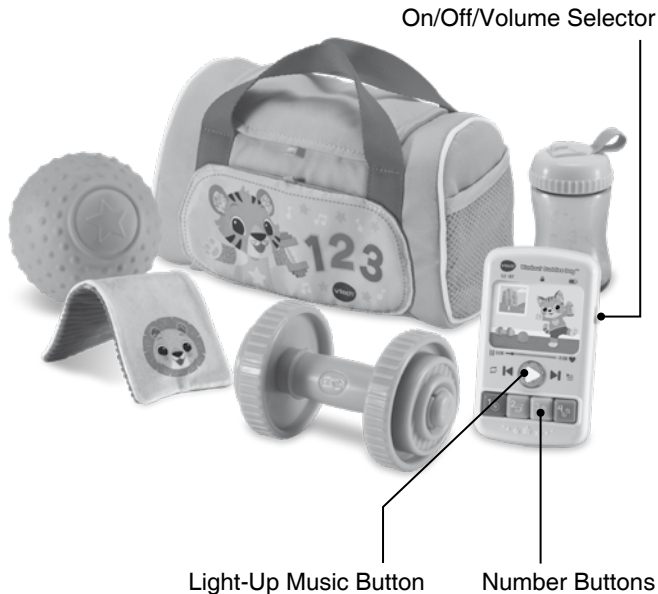

On/Off/Volume Selector

Light-Up Music Button

Number Buttons

INCLUDED IN THE PACKAGE

- **Workout Buddies Bag™**
- Music player
- Fitness ball
- Water bottle rattle
- Towel
- Dumbbell
- Quick Start Guide

WARNING

All packing materials, such as tape, plastic sheets, packaging locks, removable tags, cable ties, cords and packaging screws are not part of this toy, and should be discarded for your child's safety.

NOTE

Please save this Instruction Manual as it contains important information.

ATTENTION

Pour la sécurité de votre enfant, débarrassez-vous de tous les produits d'emballage tels que rubans adhésifs, feuilles de plastique, attaches, étiquettes et vis d'emballage. Ils ne font pas partie du jouet.

NOTE

Il est conseillé de sauvegarder ce guide d'instructions car il comporte des informations importantes.

Unlock the Packaging Locks

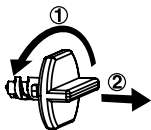

- ① Rotate the packaging locks counterclockwise 90 degrees.
- ② Pull out the packaging locks and discard.

NOTE

Please cut and discard the cable ties that attach the **Workout Buddies Bag™** to the box. The cable ties are not part of this toy and should be discarded for your child's safety.



NOTE

Merci de couper et jeter les attaches qui retiennent le jouet dans l'emballage. Pour la sécurité de votre enfant, débarrassez-vous de ces attaches, elles ne font pas partie du jouet.

GETTING STARTED

Battery Removal and Installation

1. Make sure the unit is turned **Off**.
2. Find the battery cover located on the back of the music player. Use a screwdriver to loosen the screw and then open the battery cover.
3. Remove old batteries by pulling up on one end of each battery.
4. Install 2 new AAA batteries following the diagram inside the battery box. (The use of new alkaline batteries is recommended for maximum performance.)
5. Replace the battery cover and tighten the screw to secure.

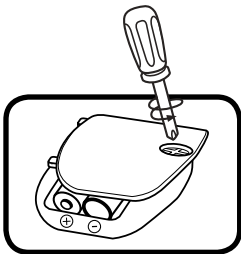

WARNING:

Adult assembly required for battery installation.
Keep batteries out of reach of children.



ATTENTION :

Les piles ou accumulateurs doivent être installés par un adulte.
Tenir les piles ou accumulateurs hors de portée des enfants.

IMPORTANT: BATTERY INFORMATION

- Insert batteries with the correct polarity (+ and -).
- Do not mix old and new batteries.
- Do not mix alkaline, standard (carbon-zinc) or rechargeable batteries.
- Only batteries of the same or equivalent type as recommended are to be used.
- Do not short-circuit the supply terminals.
- Remove batteries during long periods of non-use.
- Remove exhausted batteries from the toy.
- Dispose of batteries safely. Do not dispose of batteries in fire.

RECHARGEABLE BATTERIES

- Remove rechargeable batteries from the toy before charging.
- Rechargeable batteries are only to be charged under adult supervision.
- Do not charge non-rechargeable batteries.

IMPORTANT : INFORMATIONS CONCERNANT LES PILES

Les piles fournies avec le produit permettent de tester le jouet en magasin mais ne sont pas des piles longue durée.



- Mettre en place les piles ou les accumulateurs en respectant les polarités + et -.
- Ne pas mélanger des piles ou des accumulateurs neufs avec des usagés.
- Ne pas mélanger différents types de piles : alcalines, zinc-carbone et rechargeables.
- Seules des piles du type recommandé doivent être utilisées.
- Ne pas mettre les bornes d'une pile ou d'un accumulateur en court-circuit (en reliant directement le + et le -).
- Retirer les piles ou les accumulateurs en cas de non-utilisation prolongée.
- Enlever les piles ou les accumulateurs usagés du jouet.
- Ne les jeter ni au feu ni dans la nature.

PILES RECHARGEABLES

- Enlever, lorsque c'est possible, les accumulateurs du jouet pour les recharger.
- Les accumulateurs ne doivent être chargés que sous la surveillance d'un adulte.
- Ne pas tenter de recharger des piles non rechargeables.

PRODUCT FEATURES

1. On/Off/Volume Selector

To turn the unit **On**, slide the **On/Off/Volume Selector** to the Low volume  or the High volume  position. You will hear a phrase and a song. To turn the unit **Off**, slide the **On/Off/Volume Selector** to the **Off**  position.

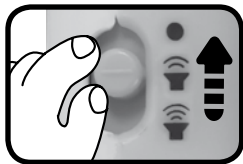

2. Automatic Shut-Off

To preserve battery life, the **Music Player** will automatically shut off after each audio response. The unit can be turned on again by pressing any button or by sliding the **On/Off/Volume Selector**.

NOTE

This product is in Try-Me mode in the packaging. After opening the package, turn the **Music Player** off and on again to proceed with normal play. If the unit powers down or if the light fades out during play, please install a new set of batteries.

ACTIVITIES

1. Number Buttons

Press the **Number Buttons** to learn about fitness tools, numbers and colors.



2. Light-Up Music Button

Press the **Light-Up Music Button** to hear upbeat songs and music for exercising and relaxing music for cool down. The light will flash with the sounds.



MELODY LIST

1. Keep Moving
2. Feel the Beat
3. Let's Go
4. One, Two, Buckle My Shoe
5. Pat-a-Cake
6. Pease Porridge Hot
7. Row, Row, Row Your Boat
8. Skip to my Lou
9. Teddy Bears' Picnic
10. Bingo
11. The Alphabet Song
12. The Bear Went Over the Mountain
13. Three Little Kittens
14. The Wheels on the Bus
15. Bicycle Built for Two
16. Boys and Girls Go Out to Play
17. Baby Bunting

18. A-Tisket, A-Tasket
19. Did You Ever See a Lassie?
20. Green Grass Grew All Around

SONG LYRICS

Song 1

Jumping, grooving and dancing
Rolling, moving and spinning
Will all help you stay healthy,
And keep you energized!

Song 2

Come on!
One, raise your hands up.
Two, wiggle your feet out.
Three and four, move about.
Exercising with you is fun!

Song 3

One and two and three and four.
Move your body, go, go, go!

CARE & MAINTENANCE

1. Keep the unit clean by wiping it with a slightly damp cloth.
2. Keep the unit out of direct sunlight and away from any direct heat sources.
3. Remove the batteries if the unit will not be in use for an extended period of time.
4. Do not drop the unit on hard surfaces and do not expose the unit to moisture or water.

TROUBLESHOOTING

If for some reason the unit stops working or malfunctions, please follow these steps:

1. Turn the unit **Off**.
2. Interrupt the power supply by removing the batteries.
3. Let the unit stand for a few minutes, then replace the batteries.
4. Turn the unit **On**. The unit should now be ready to use again.
5. If the unit still does not work, install a new set of batteries.

IMPORTANT NOTE:

If the problem persists, please call our **Consumer Services Department** at **1-800-521-2010** in the U.S. or **1-877-352-8697** in Canada, or by going to our website at **vtechkids.com** and filling out our **Contact Us** form located under the **Customer Support** link. Creating and developing **VTech®** products is accompanied by a responsibility that we take very seriously. We make every effort to ensure the accuracy of the information, which forms the value of our products. However, errors sometimes can occur. It is important for you to know that we stand behind our products and encourage you to contact us with any problems and/or suggestions that you might have. A service representative will be happy to help you.

CAUTION

Changes or modifications not expressly approved by the party responsible for compliance could void the user's authority to operate the equipment.

NOTE

This equipment has been tested and found to comply with the limits for a Class B digital device, pursuant to Part 15 of the FCC Rules. These limits are designed to provide reasonable protection against harmful interference in a residential installation. This equipment generates, uses and can radiate radio frequency energy and, if not

installed and used in accordance with the instructions, may cause harmful interference to radio communications. However, there is no guarantee that interference will not occur in a particular installation. If this equipment does cause harmful interference to radio or television reception, which can be determined by turning the equipment off and on, the user is encouraged to try to correct the interference by one or more of the following measures:

- Reorient or relocate the receiving antenna.
- Increase the separation between the equipment and receiver.
- Connect the equipment into an outlet on a circuit different from that to which the receiver is connected.
- Consult the dealer or an experienced radio/TV technician for help.

Supplier's Declaration of Conformity
47 CFR § 2.1077 Compliance Information

Trade Name:	VTech®
Model:	5480
Product Name:	Workout Buddies Bag™
Responsible Party:	VTech Electronics North America, LLC
Address:	1156 W. Shure Drive, Suite 200 Arlington Heights, IL 60004
Website:	vtechkids.com

THIS DEVICE COMPLIES WITH PART 15 OF THE FCC RULES. OPERATION IS SUBJECT TO THE FOLLOWING TWO CONDITIONS: (1) THIS DEVICE MAY NOT CAUSE HARMFUL INTERFERENCE, AND (2) THIS DEVICE MUST ACCEPT ANY INTERFERENCE RECEIVED, INCLUDING INTERFERENCE THAT MAY CAUSE UNDESIRE OPERATION.

**Visit our website for more
information about our products,
downloads, resources and more.**

vtechkids.com
vtechkids.ca

Read our complete warranty policy online at
vtechkids.com/warranty
vtechkids.ca/warranty



TM & © 2021 VTech Holdings Limited.

All rights reserved.

Printed in China.

91-004013-000 (US) (CA)